

Mountain View VOICE

1st Place
GENERAL
EXCELLENCE

California Newspaper Publishers Association

SEPTEMBER 9, 2016 VOLUME 24, NO. 33

www.MountainViewOnline.com

650.964.6300

MOVIES | 25



MICHELLE LE

Leslie Carrillo-Lorenzo, a senior at Mountain View High School, shows family and friends the miniature deep sea robot she built while aboard the research vessel Nautilus this summer.

Teen takes a deep dive on research vessel

MVHS SENIOR SPENT HER SUMMER LEARNING TO PILOT A DEEP-SEA ROBOT

By Kevin Forestieri

Last month, Mountain View High School senior Leslie Carrillo-Lorenzo got to pilot one of the world's most advanced deep-sea robots. Sitting in the control room aboard the research vessel Nautilus, she had only a few minutes to figure out the controls for

the 5,000-pound robot, named Hercules, as it floated thousands of feet below the ocean's surface. "I was driving Hercules down 2 miles below the surface, exploring part of the ocean nobody has ever seen," she said. "You're the one driving it, and showing the video feed to millions of people."

Driving Hercules into the

ocean depths off the coast of Southern California was one of many once-in-a-lifetime experiences Carrillo-Lorenzo had during her one-week trip on the Nautilus, as part of a summer program to introduce teens to ocean exploration and robotics. She got to share her experience

► See *DIVE*, page 8

Surviving 9/11, still

MOUNTAIN VIEW WOMAN REMEMBERS CHAOS AND THE BROTHER SHE LOST AT WORLD TRADE CENTER

By Sue Dremann

It's been 15 years since terrorists drove planes deep into the sides of New York City's Twin Towers, but for survivor Lori Schertzer Brody, the flash-

backs are fresh: the sounds of the planes striking the buildings, the smoke and debris, the fear and pandemonium — and so much running.

Brody, now a Mountain View resident, and her brother, Scott

Schertzer, had prepared for work as usual on that sunny Sept. 11. Neither sensed it would be their last time together, but looking back, Brody said there were signs.

Scott Schertzer seemed to have premonitions in the form of nightmares in the month prior to the attacks, and they frightened him.

"He knew it was coming," she recalled.

But she thought at the time that his upset had to do with his

job: Brody worked in human resources at Cantor Fitzgerald, a financial services firm, and was going to have to lay off 50 people. It was a heavy burden for a 28-year-old, she said.

"He kept saying, 'They're after me. The bad guys are coming. The dreams are happening.' He couldn't figure out what was going on. All he kept telling people was that he wanted to be with family and how much he loved them," she said.

But even the night after the layoffs on Sept. 10, he dreamed that the people he laid off were following him. The next morning, Sept. 11, he didn't want to go to work, she said.

But Brody made him go. She had helped her brother, who was younger, get his job at Cantor Fitzgerald, and she had worked there herself the year before, she said.

► See *9/11*, page 15

Council backs Shoreline bus lane project

PLAN AIMS TO BOOST TRAFFIC SAFETY ALONG ONE OF THE CITY'S BUSIEST STREETS

By Kevin Forestieri

The Mountain View City Council agreed Tuesday night to move forward on plans to radically change Shoreline Boulevard as it approaches North Bayshore, endorsing a bus lane and a series of bike and pedestrian improvements aimed at making it safer to travel down the busy thoroughfare.

In a 5-1 vote, with council member Mike Kasperzak absent and John Inks opposed, the council agreed on conceptual plans to add a 12-foot-wide, single bus lane that would

allow transit vehicles, including private employer shuttles and VTA buses, to travel northbound in the morning commute and southbound during the evening. The project also calls for widened bike lanes, as well as a 2-foot-wide physical buffer between vehicle and bike lanes between Middlefield Road and Terra Bella Avenue.

The bus lane is intended to

serve as an important last-mile connection between the downtown transit center and the jobs-heavy North Bayshore region, according to Mike Fuller, the city's public works director. The project is one of several measures the city is expected to take to reduce the number of single-occupancy vehicles heading into North Bayshore by 45 percent.

Though the bus lane would span about two-thirds of a mile, from Middlefield Road to Pear Avenue, most of the traffic safety measures are focused on the major intersection of Middlefield and Shoreline.

The plan calls for a "protected intersection," with a dedicated bicyclist crosswalk and physical barriers that extend into the intersection on each corner, which are intended to increase visibility of bicyclists and pedestrians waiting for the traffic signal.

Four bus stops, including two

'The exact benefit of this dedicated lane is not clear to me.'

COUNCILMAN JOHN INKS

► See *BUS LANE*, page 6



**JUDY
BOGARD-TANIGAMI**

650.207.2111

judybt@apr.com

CalBRE# 00298975

**SHERI
BOGARD-HUGHES**

650.279.4003

shughes@apr.com

CalBRE# 01060012

**CINDY
BOGARD-O'GORMAN**

650.924.8365

cbogardogorman@apr.com

CalBRE# 01918407

ConsultantsInRealEstate.com

Ranked Among Top Agents in the Wall Street Journal for 8 Consecutive Years



3386 Awalt Drive, Mountain View

Outstanding Opportunity in Waverly Park Area!

4 bedroom, 2 bathroom home located at the end of a cul-de-sac offers home buyers and contractors a wonderful opportunity to create your dream home in this sought-after Mountain View neighborhood. Open floor plan with approximately 2,088* square feet on one level provides flexibility for creating a great room concept and much more! Good size yard offers ample possibilities for your own private oasis. Excellent Mountain View schools.

Offered at \$1,495,000 • www.3386AwaltDrive.com



- 4BD/2BA with approx. 2,088* square feet of living area
- Cul-de-sac location on approximately 8,400+* square foot lot
- Step down living room with raised hearth brick fireplace
- Kitchen features breakfast nook and pantry
- Formal dining room
- Separate family room with sliding door to back yard
- Master Bedroom has two closets and sliding doors to rear yard
- Good size additional bedrooms
- 4th bedroom/office on opposite side of home
- Indoor laundry room
- Generous sized 2-car garage
- Ample storage throughout
- Good size yard with patio and generous side yard
- Sought-after Huff Elementary, Graham Middle and Mountain View High (buyer to verify enrollment)
- Ideal location near YMCA, Cuesta Park, and major commuter routes

*buyer to verify



89 Alma Court, Los Altos

North Los Altos Contemporary

Excellent opportunity to own this wonderful home in highly sought-after North Los Altos. Only moments from the Village of Los Altos, this updated 4 bedroom 3.5 bathroom home features a bright open floor plan with 3 suited bedroom. One bedroom is located on the opposite end of the home providing flexibility for au-pair, in-laws, or guests. Features of the home include a large great room/kitchen area, living room with vaulted ceiling and wood-burning fireplace, new flooring, plush designer carpeting in the bedrooms, updated kitchen and bathrooms, and freshly painted inside and out. Large windows and sliding glass doors provide natural sunlight throughout. The private fenced backyard features lush lawn. Top-rated Los Altos schools.

Offered at \$3,198,000 • www.89AlmaCourt.com



- 4 bedrooms and 3.5 bathrooms
- Approximately 2,727* square feet of living space
- Lot size is approximately 10,000* square feet
- Large living room with wood-burning fireplace and vaulted ceiling
- Spacious and light-filled great room/kitchen area with access to the backyard
- Updated kitchen and bathrooms
- Mostly new kitchen appliances, and new finishes throughout include new flooring, lighting, plumbing fixtures, and interior doors
- Abundant light with large sliding glass doors and skylights
- 2 car garage with new epoxy floor
- Private backyard with patio and expansive lush lawn
- Top-rated Los Altos schools include Santa Rita Elementary, Egan Jr. High and Los Altos High (buyer to verify enrollment)

*buyer to verify

Voices

A R O U N D T O W N

Asked in downtown Mountain View. Photos and interviews by Sanjana Garg

What were you doing when you heard the news on 9/11?



"My parents woke me up in the morning. I must have been a sophomore. We went downstairs and turned on the TV. I remember we talked about it all day in the classroom."

Anthony Behn, Mountain View



"I was in seventh grade. I knew that the Trade Center was relevant and it caused me enough pause that I fell out of my chair."

Julian Aris, Mountain View



"I had just had my wedding in Italy the day before. Some Americans came and told us what had happened, and actually Flight 93 was still in the air. I was in shock. I just couldn't believe it."

Monica Nocciola, Palo Alto



"I was in fourth grade and I remember being really confused. Then they turned on the TVs for the teachers to watch."

Kaitlin Self-Aris, Mountain View



"I was in a new apartment in San Diego. I think the first thing was the shock. I was listening to the radio and they were saying something about a plane going into the towers."

Krissy Green, Palo Alto



NO DENTAL INSURANCE? NO PROBLEM!

Introducing

Smiles Dental Membership Program.

ADULT \$299

PER YEAR PER PERSON

(Value \$597. Includes 2 teeth cleaning visits, 2 exams & x-rays, in a 12 month period & dental treatment is discounted for members.)

LEARN MORE AT SMILESDENTAL.COM

Second opinions welcome. Call for details.

SMILES DENTAL CARE
QUALITY · SATISFACTION · TRUST

100 W. El Camino Real, Suite 63A
Mountain View
(Corner of El Camino & Calderon)

650.665.5001



Kozy Brothers
De Martini Orchard
www.demartiniorchard.com
66 N. San Antonio Rd., Los Altos
650-948-0881

Open Daily 8am-7pm
Prices Effective 9/7 thru 9/13

Farm Fresh and Always the Best



<p>SAN JOSE GROWN WHITE CORN IN HUSK SUPER SWEET FRESH DAILY 4 EARS FOR \$2.00</p>	<p>TOMATO SEASON STARTS NOW LOS ALTOS HILLS TOMATOES HEIRLOOMS FANTASTIC FLAVOR \$3.99 LB. RED GARDEN EARLY GIRL BIG BEEF \$2.99 LB. MIXED CHERRY LOT OF COLOR TASTY \$5.99 LB.</p>	<p>NATURALLY GROWN GIZDICH RANCH APPLES HONEY CRISP GALA MUTSU MAC NO SPRAY NO WAX 2 LBS FOR \$4.00</p>
<p>SWEET PEPPERS LOCAL RED OR YELLOW \$1.99 LB.</p>	<p>ORGANIC LOCAL GREEN BEANS TENDER BLUE LAKE \$1.49 LB.</p>	<p>NORTHWEST ITALIAN PRUNES SWEET TASTY \$1.49 LB.</p>
<p>ORGANIC LOCAL ZUCCHINI COLORED SQUASH \$1.29 LB.</p>	<p>ORGANIC LOCAL BROCCOLI 2 BUNCH FOR \$4.00</p>	

Your Everyday Farmers Market
Online at www.DeMartiniOrchard.com

MountainView
ONLINE

LET'S DISCUSS:
Read the latest local news headlines and talk about the issues at Town Square at **MountainViewOnline.com**



Water System Flushing

The City of Mountain View will begin flushing the water system north of Cuesta Drive on August 15, 2016. Flushing helps to maintain water quality by removing accumulated sand and sediment from water lines. Signs and barricades will be posted in neighborhoods the day before flushing begins. Flushing north of Cuesta Drive is anticipated to be complete by the end of November 2016.

If you would like more information about the City's water system flushing program or have questions or concerns while City personnel are in your neighborhood, please contact the Public Services Division at (650) 903-6329 or visit the City's website at www.mountainview.gov.

SUPPORT LOCAL JOURNALISM

Support Mountain View Voice's coverage of our community.

Memberships begin at only 17¢ per day

Join today: SupportLocalJournalism.org

CRIME BRIEFS

PURSE-SNATCHING ARREST

A transient who allegedly attempted to steal a woman's purse in downtown Mountain View on Monday evening was found in hiding a block away, police said.

Anthony Patterson, 20, was arrested on suspicion of attempted robbery and resisting arrest, according to Mountain View police.

The suspect was seen fighting with a woman at a bus stop near the 200 block of Castro Street on Sept. 6, where officers were wrapping up their response to another call, police said.

The officers saw Patterson try to snatch the woman's purse from her shoulder, police said. He was unsuccessful in his attempt.

The officers headed to the bus stop, saw the suspect run down the road to West Dana Street and followed him, police said.

Patterson was found hiding inside a dumpster near a CVS Pharmacy and arrested, according to police.

No injuries were reported.

INJURY CAR CRASH

A suspected drunken driver suffered major injuries in a crash early Saturday morning, Mountain View police said.

Around 2:45 a.m. on Sept. 3, police officers responded to a report of a crash in the 2200 block of Old Middlefield Way. Officers discovered that a truck had struck several cars parked along the road. The truck then flipped over and landed on the ramp of an equipment trailer, according to police.

Following the crash, the driver fled the scene.

Officers found him two blocks away and said he had suffered major injuries. He was taken to a hospital.

—Bay City News Service

PALO ALTO ARSON SUSPECT ARRESTED

Palo Alto police on Tuesday night arrested an East Palo Alto man suspected of starting a fire that extensively damaged a motel room at the Glass Slipper Inn, according to a police department press release.

Investigators said the room was rented by a woman in her 20s. The woman and her estranged husband, whom she had a no-contact domestic violence restraining order against, had a verbal argument in the room. She left before the argument escalated, police said, leaving her husband alone in the room. Later the woman received a call from the motel manager informing her of the fire in her room. She returned to the motel to talk to investigators, police said.

Palo Alto fire investigators determined that the origin of the blaze appeared to be suspicious, and started an arson investigation with the police department.

An officer from the Mountain View Police Department made

► See **CRIME BRIEFS**, page 12

Healthy Teeth and Gums That Last a Lifetime!



- Experienced and Gentle Dentist, and Friendly Staff
- New Patients Welcome!
- Free Consultations and Second Opinions
- Saturday Appointments Available

Voted Best Dentist

DENTAL FABULOUS
Cosmetic & Family Dentistry

Don't Wait! Call 650.969.6077 for your appointment today!



Conveniently located in Downtown Mountain View
756 California Street, Suite B
Mountain View 94041
cross street: Castro, next to Bierhaus

650.969.6077
dentalfabulous.com



POLICE LOG

ATTEMPTED ROBBERY
200 block Castro St., 9/5

2500 block California St., 8/31
500 block San Antonio Rd., 9/2

AUTO BURGLARY
600 block San Antonio Rd., 8/31
800 block N. Rengstorff Av., 9/1
1100 block N. Rengstorff Av., 9/1

RESIDENTIAL BURGLARY
1600 block Grant Rd., 8/31
500 block Del Medio Av., 8/31
500 block Del Medio Av., 9/1
100 block Frederick Ct., 9/1
1000 block Crestview Dr., 9/5

BATTERY
200 block Castro St., 9/5

COMMERCIAL BURGLARY
2600 block W. El Camino Real, 8/31
1600 block W. El Camino Real, 9/2
1400 block W. El Camino Real, 9/2
500 block Showers Dr., 9/3

STOLEN VEHICLE
W. Evelyn Av. & Franklin St., 8/31
N. Shoreline Blvd. & Terra Bella Av., 9/1
2600 block California St., 9/2
2300 block Rock St., 9/2
2200 block Rock St., 9/5

GRAND THEFT
200 block S. Rengstorff Av., 8/31

The Mountain View Voice (USPS 2560) is published every Friday by Embarcadero Media, 450 Cambridge Ave, Palo Alto CA 94306 (650) 964-6300. Periodicals Postage Paid at Palo Alto CA and additional mailing offices. The Mountain View Voice is mailed free upon request to homes and apartments in Mountain View. Subscription rate of \$60 per year. POSTMASTER: Send address changes to Mountain View Voice, 450 Cambridge Ave, Palo Alto, CA 94306.



PHOTO BY MICHELLE LE

A WILDLIFE REFUGE IN TECHVILLE

Google broke ground on a project last week to revitalize the Charleston Retention Basin, restoring roughly 4 acres of wildlife habitat located on the company's campus. The restoration project has been three years in the making, and is expected to become a resource for Mountain View residents and campus visitors seeking to take a stroll through nature.

City Council agrees to pursue housing in East Whisman

LARGE AREAS OF THE OFFICE-HEAVY REGION COULD BE RE-ZONED

By Kevin Forestieri

One of Mountain View's office-heavy jobs centers could be an epicenter of new housing, after City Council members Tuesday night voiced broad support for re-zoning parts of the East Whisman area for residential growth.

The Sept. 6 meeting marked the first of several scheduled study sessions on the East Whisman Precise Plan, part of a larger strategy to increase housing throughout the city.

The area is roughly bounded by Highway 101, North Whisman Road, Central Expressway and the city of Sunnyvale and is cur-

rently zoned for light industrial and does not allow for residential use.

The key question at the council meeting wasn't whether to add housing to the area, but where it should go and at what density. Also part of the discussion was

► See **EAST WHISMAN**, page 16

Effort to take council-backed rent control off ballot falls short

By Andrea Gemmet

It appears that Gary Wesley's legal fight to remove the Mountain View City Council-backed rent control measure from the November ballot came a little too late.

Wesley, a Mountain View resident and attorney, sought to remove Measure W from the Nov. 8 ballot. He announced Aug. 30 that he had filed a law-

suit, saying the City Council had no authority to place the measure on the ballot. He sought to have Measure W removed, along with references to it in the official ballot arguments. On Tuesday, a Santa Clara County Superior Court judge denied Wesley's request.

In court on Tuesday, Sept. 6, testimony from the county's assistant registrar of voters said that it was too late to make

changes to the ballot, and the voter information pamphlets with ballot arguments, without risking the timely printing of ballot materials. Judge William Elfving denied Wesley's request to set court dates to hear the case, essentially scuttling the lawsuit.

Wesley pointed out that the judge's denial did not touch on the merits of his case.

► See **BALLOT**, page 7

Trustees clash over neighborhood outreach

MEETINGS ON MOUNTAIN VIEW WHISMAN TEACHER HOUSING DRAW SUPERINTENDENT'S IRE

By Kevin Forestieri

Emotions ran high at the Mountain View Whisman School District board meeting Thursday night, after a discussion about a board member holding impromptu meetings on teacher housing turned into a heated argument between trustee Steve Nelson and the superintendent.

The board was scheduled to discuss board bylaws at the Sept. 1 meeting, but it quickly became clear that the agenda item was about Nelson's actions over the last month. Superintendent Ayinde Rudolph revealed at the meeting that Nelson had, on his own, set up three community meetings and a survey with residents living near Cooper Park, designed to gauge whether the community would accept a below-market-rate housing project in the neighborhood.

Earlier this year, the district began exploring options for a teacher housing project that could improve faculty retention. Because land acquisition comes with a big price tag in the Bay Area, district officials said they would start by looking at district-owned land for a housing project. The district owns "excess" land at the former Whisman and Slater Elementary sites, Sylvan Park, and just under 10 acres at Cooper Park.

No official plan has been announced by the school district, and the board hasn't given direction on where to consider teacher housing, but that didn't stop Nelson from starting his own community outreach to see if residents around Cooper Park would be happy with an affordable housing project.

That didn't sit too well with board president Ellen Wheeler or with Rudolph. After the trustees received a letter from a Waverly Park resident voicing "extreme opposition" to plans for a below-market-rate housing development, Wheeler requested that Nelson cease what she called "personal canvassing."

Rudolph announced at the Sept. 1 meeting that postcards would be sent out to residents in

the area clarifying that there has been no board direction on what to do with land at Cooper Park.

Rudolph argued it was misleading and inappropriate for Nelson to host multiple community meetings on teacher housing using his title as a Mountain View Whisman School District trustee, and that district staff had to deal with inquiries from confused residents about a project that isn't even in the works. It is fine for board members to host "coffees" and other general outreach events, he said, but setting up surveys and organizing meetings on specific issues facing the district such as land use decisions and labor negotiations crosses the line.

"Talking is fine; however, when it's going to impact a potential issue that is going to be brought to the board, that's when I think you're starting to cross the line."

Nelson fired back at the meeting, saying Wheeler's "edict" to cease his outreach activities constrains his right to free speech and prevents him from reaching his constituents. Following the meeting, Nelson told the *Voice* in an email that it would be irresponsible for the district to impose rules whereby every topic-specific meeting with the public had to be sanctioned by the superintendent.

"To expect pre-approval by a mayor, city manager, board president or superintendent is ludicrous, stupid, dumb and entirely inappropriate," he said.

Nelson argued that Rudolph also broke his own rule on representing the district on personal business. Rudolph included his title as superintendent when he signed the argument in favor of Measure V, a Mountain View ballot measure that would restrict annual rent increases to between 2 and 5 percent.

"If you want to write that you are supporting a ballot measure, and you put as a designation MVWSD superintendent, that gives the impression that our school district, that you represent, is endorsing a particular measure that is on our ballot,"

► See **TEACHER HOUSING**, page 12

BUS LANE

► Continued from page 1

in the median, are also planned at the Terra Bella and Shoreline intersection.

Vice Mayor Ken Rosenberg called the bike and pedestrian improvements along the congested road the most important part of the project, although much of the discussion centered on the usage of the bus lane. He said he didn't want to bank on future plans for a bike and pedestrian bridge that may or may not be developed in the long term when there are significant upgrades that can be made in the next few years.

"The way I look at this is, we're having pedestrian and bike infrastructure that we're working on, and we're getting a dedicated (bus) lane as part of the project," Rosenberg said.

To make room for the bus lane, the city will have to remove the median along the roadway, which means 40 trees must be removed, and the left-turn lane onto southbound Highway 85 will also be eliminated. With no access to Highway 85 from northbound Shoreline, the city staff report suggested, commuters could

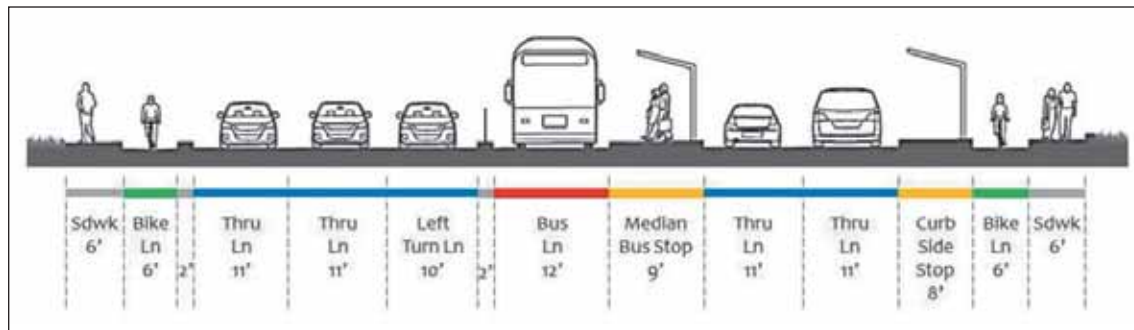

Conceptual designs for **Shoreline Boulevard** improvements include a reversible bus lane in the median, protected bike lanes and bus stops in the median of the road.

head down a circuitous route south on Shoreline, east on Middlefield and north of Moffett Field for highway access. Usage of the left-turn lane onto the highway is relatively low during the peak hours, with only 100 vehicles using it between 7 and 10 a.m., according to the staff report.

Council member Lenny Siegel said he was concerned about how difficult it would be for buses to enter and exit the strip of bus lane installed in the middle of Shoreline, which he said would have the unintended consequence of forcing buses into mixed-use lanes for freeway access. Under the conceptual plan, southbound buses would not be able to make a right turn from the bus lane

onto Highway 85 or 101, which is likely a common route buses take after dropping employees off, Siegel said.

"I would like to see more analysis done about how buses can get on or off in the middle of this whole strip of the median lane," Siegel said. "I'd hate to go through all the trouble to build this thing for \$12.5 million and have a third of the buses not be able to use it."

The city would also need to acquire a strip of between 4 and 6 feet of private property along the corridor near the Middlefield and Terra Bella intersections from nine property owners. Fuller said the estimated cost of the acquisition two years ago was \$2.5 million, but that the amount should be seen as

a minimum and a very rough estimate.

Although council member Inks said he agreed that the protected bike lanes would be a good idea, he said he could not support the plan because it wasn't clear that enough fact-finding and analysis were done to verify that the bus lane would actually be put to good use.

"The exact benefit of this dedicated lane is not clear to me," Inks said.

While residents attending the meeting largely supported protected bike lanes and the physical barrier, there was some concern that the buffer could make it hard for local businesses to operate on the street. Cindy Wong, representing the business Harry K. Wong on

Shoreline Boulevard, said they rely on the existing road space to support freight trucks traveling onto their property, and that the 2-foot physical barriers would decrease overall usability of the street for businesses.

"The buffer would make it impossible for larger freight trucks to enter the driveway," she said.

Council members asked staff to figure out whether it would be feasible to add a recycled water pipeline from North Bayshore to south of Highway 101, taking advantage of the trenching process for street improvements to lay down the pipes that could one day bring recycled water into the southern side of the city.

Adding recycled water pipes to Shoreline Boulevard ranked relatively low on the city's most recent feasibility study, but Mayor Pat Showalter said the city's public works staff ought to revisit the possibility of laying down the pipeline, particularly in light of the drought.

The city is expected to have a detailed design of the project by next summer, with construction tentatively scheduled to begin in fall 2017. ▀

Email Kevin Forestieri at kforestieri@mv-voice.com

Now is the time!

The new Foothill College Sunnyvale Center is the place.

Classes begin Sept. 26

FOOTHILL COLLEGE
foothill.edu/sunnyvale

BALLOT

► *Continued from page 5*

In August, Measure W was approved by the council after supporters of Measure V, a citizen-backed rent control measure, gathered enough signatures to qualify it for the Nov. 8 ballot.

“In the event Measure W were to pass and Measure V were to not pass, anyone — including a landlord — could challenge Measure W in court on the basis that the City Council never had

the legal authority under the City Charter to have placed the competing measure on the ballot for enactment by voters,” Wesley said via email on Tuesday.

City Attorney Jannie Quinn has maintained that, under California’s elections code, the

City Council has every right to vote to place a measure on the ballot. Wesley argued that, as a charter city, Mountain View lacks such authority.

Quinn said last week that Mountain View is a charter city that has chosen to follow the state election code, so the council is well within its rights.

“The (election code’s) purpose ... is to allow charter cities the option to enact alternative procedures for the initiative and referendum process; not to yield the absurd conclusion of invalidating (the) elections code,” the city’s rebuttal says.

“The city remains confident the City Council is authorized to submit Measure W to the voters and is pleased with the outcome of the hearing this

morning,” Quinn told the *Voice* via email.

Wesley has been deeply critical of the council-backed Measure W, which critics have called an attempt to confuse and divide voters. The California Apartment Association, a landlord advocacy group, shared polling results with some council members that reportedly show that a majority of Mountain View’s likely voters support some form of rent control.

Put forward as a city charter amendment by the Mountain View Tenants

Coalition, Measure V would tie rent increases to increases in the consumer price index, with exceptions granted by an oversight board for necessary repairs and upgrades. Measure W, described by some council

members as a less onerous alternative, revives a binding arbitration program that the council dropped from a renter relief ordinance approved in April. Among other things, if Measure W passes, tenants could dispute rent increases of over 5 percent in a year, compelling landlords to participate in binding mediation with an arbitrator.

Like all rent stabilization measures in California, both measures V and W would apply only to apartments built before 1996 and their provisions cannot be imposed upon newer rental units. If both measures pass, the citizen-backed Measure V would take precedence, according to city officials. ■

Email Andrea Gemmet at editor@mv-voice.com

If both measures pass, the citizen-backed Measure V would take precedence.

OBITUARY

JOANNE BREITMEYER

JoAnne Breitmeyer died Aug. 14 in Palo Alto following a long illness. She was 69.

Born March 25, 1947 in Detroit, she attended the University of Texas and Boston University, and got her first job at the Pentagon. In 1970, she moved to Mountain View to begin her career in the high tech industry, starting at Fairchild Semiconductor, where she began her lifelong friendship with Edwin Turney, a founder of Advanced Micro Devices.

She founded and led Brieday, Inc. in the 1970s and ‘80s, providing graphic arts services to many local companies, and later worked as an executive assistant at Hewlett-Packard and Agilent Technologies.

She was active in the South Bay community for 35 years, including with the Northern California Arthritis Association and Peninsula Children’s Center Charter Auxiliary, and she managed charitable giving for the United Way at Hewlett-Packard.

She is survived by her siblings, Melinda Breitmeyer of Palo Alto, James Breitmeyer of Rancho Santa Fe, Calif., and Philip (Skip) Breitmeyer of Manhattan, Kansas.

Arrangements for the funeral service are pending.



JoAnne Breitmeyer



Stanford MEDICINE

What You Need to Know About Prostate Cancer

A COMMUNITY TALK

Prostate cancer is one of the most common cancers in men and can be successfully treated if caught early. Join Stanford Medicine doctors as they discuss the latest screening, diagnostic tools and treatment advancements, including:

- Diagnostic tests such as MRI and fusion-targeted biopsy
- Treatments including robotic surgery, high-dose radiation therapy, focused ultrasound, and chemotherapy

Stanford’s prostate cancer experts will share the latest information and answer your questions.

SPEAKERS

Eila Skinner, MD
Chair, Department of Urology

Sandhya Srinivas, MD
Medical Oncologist

Mark Buyyounouski, MD, MS
Radiation Oncologist

Geoffrey Sonn, MD
Urologic Oncologist

Sat, Sept 10
9:30AM – 11:00AM

Sunnyvale Community Center
@ the Senior Center
550 E. Remington Drive
Sunnyvale, CA

Reserve your space

Free and open to the public
Seating is limited. Please register at
stanfordhealthcare.org/events
or by calling **650.736.6555**.



DIVE

► Continued from page 1

aboard the ship with family and her peers on the high school robotics team when the Nautilus docked in San Francisco last week.

While aboard the ship, Carrillo-Lorenzo and seven other students from around the country got to work with a team of researchers in Southern California, logging everything they could find along a geologically active area 100 kilometers off the coastline. The team explored the complex geography of ridged boundaries and basins between the North American and Pacific plates that lie along the San Andreas Fault — an area that remains mostly unexplored.

During all of the Nautilus expeditions, exploration footage is broadcast online via a live stream at nautiluslive.org, so anyone can witness encounters with sea creatures or unusual geological formations in real time. While in Southern California, the crew encountered two “whale falls,” an ecosystem that develops around whale skeletons, sharks and a cute purple stubby squid (which generated millions of hits on YouTube).

Guiding a tour of the ship, Carrillo-Lorenzo showed off where the heart of these observations take place — the control room. The dark room is equipped with



MICHELLE LE

Leslie Carrillo-Lorenzo shows her mother around the Nautilus on Aug. 28, when the research vessel docked in San Francisco.

21 monitors showing deep-sea mapping and multiple angles of underwater video feeds. Researchers and robot pilots in the room act as the narrators, and at times the entertainers, for anyone watching the stream.

Anything going on below the surface is broadcast on monitors in nearly every room of the ship, giving anyone interested a chance to watch what’s happening on the ocean floor.

Directly below the control room is the kitchen, where just about every jar and container has to stick to a table or risk toppling over from the constant motion of the ship. Carrillo-Lorenzo recalled a time when one person eating in the kitchen flew out of a chair and across the room after an unexpected jolt.

Turning a constant stream of data coming from Hercules into something valuable to researchers is a challenge in its own right. After a four-hour session logging everything that Hercules observes, Carrillo-Lorenzo and the rest of the students would head down to the data lab and work on isolating the footage of interest. Ashley Marranzino, a graduate student aboard the Nautilus, said it’s part of a long process to turn a constant stream of data into a useful report for researchers around the world.

“We take the hundreds of observations and condense it down to a one-page document,” Marranzino said.

All of this deep-sea research wouldn’t be possible without the two robots aboard the Nautilus, Argus and Hercules, which are remotely-operated vehicles (ROVs) capable of gathering information, taking samples and giving researchers a glimpse of what goes on thousands of feet underwater. The two robots play different roles, but are interdependent.

Argus’ main job is to act as an anchor for Hercules, according

to Reuben Mills, the ROV pilot for Nautilus. It also provides light at the bottom of the ocean by way of 1,200-watt arc lamps capable of producing extraordinary amounts of brightness — over 100,000 lumens each. Unlike Hercules, which is controlled by six thrusters, Argus’ movement is controlled by the ship on the surface, which can be a little tricky when the robot is deployed thousands of feet underwater.

“Imagine dangling a penny with a piece of dental floss off the Empire State building,” Mills said. “Argus takes six or seven minutes to actually move.”

Hercules, on the other hand, acts as the primary exploration tool, giving its pilot a chance to float around freely, collect samples and observe any wildlife in a 40-meter range around Argus. Despite weighing thousands of pounds, Hercules is buoyant in seawater because of a specialized foam pack composed of tiny hollow glass spheres. Because of its surface area, the foam pack can withstand deep-sea pressure equal to 400 atmospheres, Mills said.

While showing friends and family around the Nautilus, Carrillo-Lorenzo got to debut her own miniature version of Hercules — a small underwater robot that she built during her downtime aboard the ship. She said she hasn’t given it a name yet, but she plans to work with the rest of the Mountain View High School robotics team to add modifications prior to sending it into the water.

Ruth Lorenzo said she was proud of her daughter for completing the trip, but she was pretty nervous about her child being on

the other side of the country. Prior to traveling aboard the Nautilus, Carrillo-Lorenzo spent weeks at the University of Rhode Island for a crash course in oceanography.

“It’s the first time that she had traveled so far away,” Lorenzo said.

Julia Conant, a long-time friend of the family who came on the Nautilus tour, was ecstatic about Carrillo-Lorenzo’s accomplishments, and said it was great to hear she had piloted an advanced deep-sea — a job normally reserved for experienced senior ROV pilots.

“She’s a smart kid, I always knew she would go somewhere,” Conant said. “She is the youngest person to drive that thing!”

Carrillo-Lorenzo said she had an interest in robotics and the environment prior to her trip aboard the Nautilus, but this summer’s program sealed the deal. Her college search has now shifted to schools on the coast, including the University of California campuses at Santa Barbara and San Diego, as well as universities with a strong relationship with the National Oceanic and Atmospheric Administration.

She was originally enrolled in Freestyle Academy her senior year, a local high school program focused on art and technology, but she has since switched back to Mountain View High School in order to take advanced placement biology. Working as a researcher on the Nautilus helped give Carrillo-Lorenzo direction, and she says the renewed focus has given her a real career goal.

“It helps to know that I want to do this in the future,” she said. “There’s a goal now, there’s a prize at the end.” ■

JAZZ

at the Courtyard

FIRST SATURDAY OF THE MONTH
OCTOBER 1st, 2016

FEATURING Milt Bowerman Trio

MUSIC Great local Jazz musicians

COMMUNITY SUPPORT Attendees are invited to bring their own wine for a \$10 corkage fee. The corkage fee will be donated to Los Altos Elementary Schools, administered through the Los Altos Community Foundation.

PARKING Always complimentary underground parking

NO COVER

NO MINIMUM

WHEN Saturday 6:00 to 9:00 p.m.

WHERE 4320 El Camino Real, Los Altos On the corner of Los Altos Avenue and El Camino Real

FOR MORE INFORMATION please call 650-443-JAZZ(5299)

WE ARE
CONNECTING
OUR CLIENTS
TO GREAT
CONDOS
AND
TOWNHOMES!

CONDOCONNECT
R E A L T Y

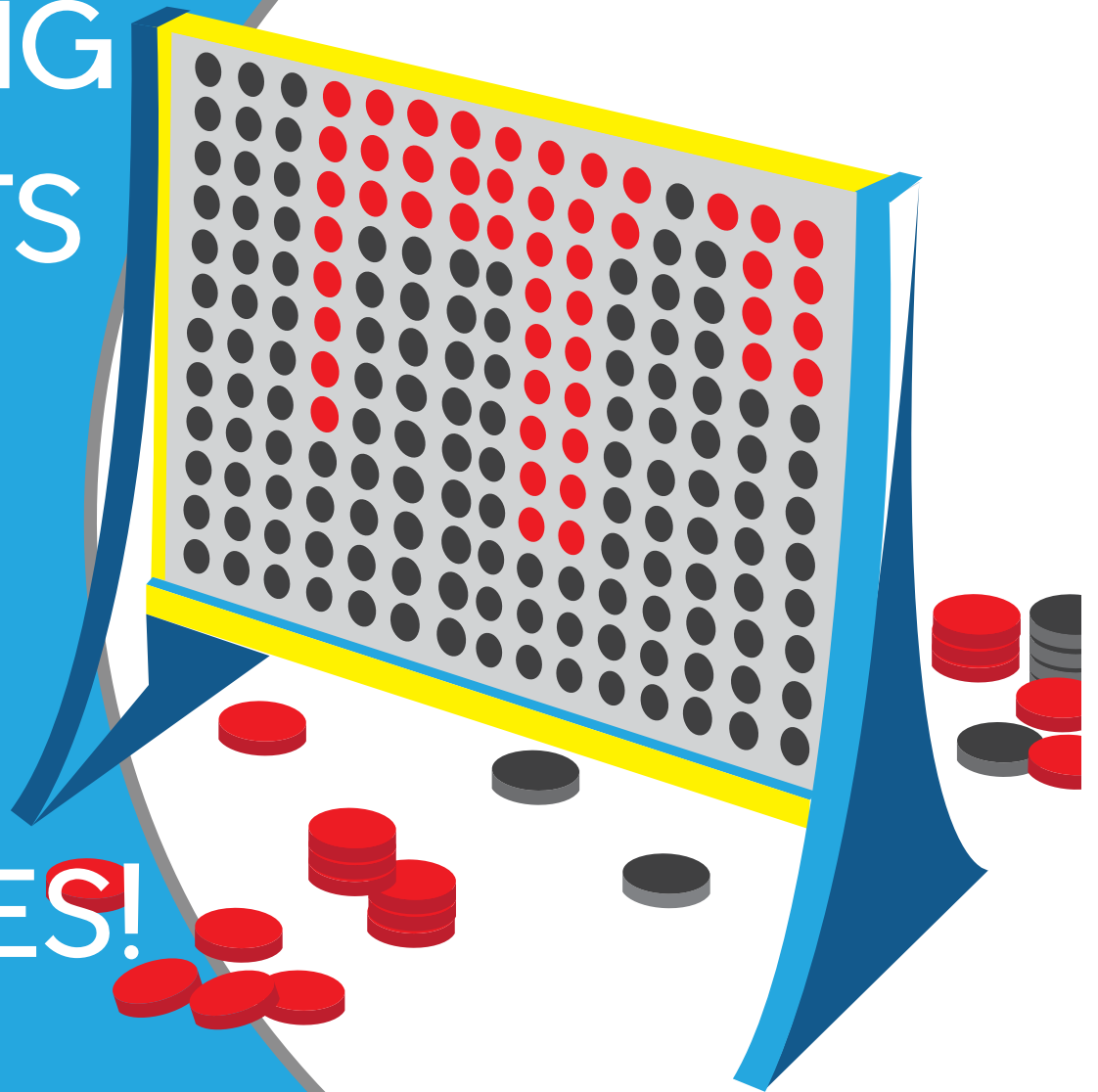

LIVE - WORK - THRIVE

WE SELL CONDOS AND TOWNHOMES
EXCLUSIVELY

Condo Connect Realty has built an expertise and understanding of condos and townhomes by focusing exclusively on their sale and purchase.

Our team understands the nuances and intricacies of homeowner association rules and regulations and ensures that buyers and sellers are completely familiar with their possible repercussions.

We also know the strengths and unique selling points of each complex and market these selling points to the broadest possible audience.

TEAM APPROACH



CONDOCONNECT
R E A L T Y

www.CondoConnectRealty.com

650.543.8536 | CaIBRE #02012195 | info@condoconnectrealty.com



175 Cuesta Drive, Mountain View Offered at \$1,488,000

Fabulously Located Home with Atrium

Enjoy living within a stroll of popular amenities in this 3 bedroom, 2 bath home of 1,336 sq. ft. (per county) that occupies a spacious property of 9,030 sq. ft. (per county).

A versatile atrium centralizes the residence, which has been freshly updated and includes a stylish kitchen, sun-lit rooms, and a newly landscaped backyard with fruit trees. Within steps of Cuesta Park, also stroll to local shopping centers and Bubb Elementary (API 920) (buyer to verify eligibility).



OPEN HOUSE

Saturday & Sunday, 1-5 pm
Complimentary
Lunch & Lattes



For video tour & more photos, please visit:
www.175Cuesta.com

650.488.7325 | info@deleonrealty.com | www.deleonrealty.com | CalBRE #01903224



1071 Embarcadero Road, Palo Alto Offered at \$1,498,000

Convenience, Privacy, and Flexibility

Tucked behind a wall of hedges for desirable privacy, this 3 bedroom, 2 bath home of approx. 1,100 sq. ft. (per county) offers a detached 1 bedroom, 1 bath unit for maximum versatility. Occupying a property of over 6,100 sq. ft. (per county), the home includes a fireplace, tasteful updates, and a sizable, inviting backyard with fruit trees. The sunny, open design enjoys hardwood floors, stone-paved bathrooms, and abundant outdoor access, plus a gracious kitchen touting granite countertops. Within steps of Edgewood Shopping Center, you can also stroll to top-performing Palo Alto schools and quickly bike to Town & Country Village and Stanford University.



OPEN HOUSE

Saturday & Sunday, 1-5 pm
Complimentary
Lunch & Lattes



For video tour & more photos, please visit:
www.1071Embarcadero.com

650.488.7325 | info@deleonrealty.com | www.deleonrealty.com | CalBRE #01903224

CRIME BRIEFS

▶ Continued from page 4

contact with the husband, Miguel Angel Gamero, 22, at about 10:30 p.m. in the 1800 block of California Street in Mountain View. Gamero allegedly brandished a large pocket knife at the officer and dared the officer to shoot him, police said. Officers were able to safely take Gamero into custody. No injuries occurred during the arrest, according to police.

Police discovered that Gamero had an outstanding felony war-

rant for a probation violation and was also in possession of methamphetamine and narcotics paraphernalia.

Mountain View police turned Gamero over to the custody of Palo Alto detectives.

Gamero was booked into the Santa Clara County Main Jail on suspicion of felony arson, felony assault with a deadly weapon on a peace officer, misdemeanor brandishing a weapon at a peace officer and possession of methamphetamine and narcotics paraphernalia (both misdemeanors).

Police said Gamero is on active

probation in San Mateo County for a prior conviction of violating a restraining order. Police are also recommending new charges of violating a restraining order as a result of the contact Gamero had with his estranged wife at the motel, police said.

The two-alarm fire occurred on the second floor of the south Palo Alto motel shortly before 9 p.m. No one was in the room when the fire broke out, police said. Firefighters from Palo Alto, Mountain View and Santa Clara County knocked down the fire at about 9:30 p.m., according to the

fire department.

Fire damage was limited to the one room, with some damage to the attic and water damage to adjoining rooms, police said.

Neither firefighters nor motel guests were injured in the incident, the fire department reported.

Twenty-three guests were evacuated as crews battled the blaze, police said. The American Red Cross assisted 11 people with emergency housing at the Cubberly Community Center in Palo Alto. The others worked out alternative housing arrangements, according to police.

Police closed off a segment of El Camino, between Ventura and Los Robles avenues, to traffic for 3 1/2 hours Tuesday night while firefighters battled the fire and checked the motel for fire extension. The roadways reopened at about 12:30 a.m.

Anyone with information about this incident is asked to call the Palo Alto Police Department's 24-hour dispatch center at 650-329-2413. Anonymous tips can be emailed to paloalto@tipnow.org or sent via text message or voice mail to 650-383-8984.

—My Nguyen and Gennady Sheyner

COASTAL CLEANUP DAY SEPTEMBER 17, 2016 | 9AM-NOON

FLICKED ALONG
N. SHORELINE BLVD.

LITTERED BUTTS END UP ON OUR COAST AND WATERWAYS WHERE THEY LEACH LEAD, ARSENIC AND OTHER HARMFUL CHEMICALS. HELP US GET THEM OUT OF OUR WATERWAYS.



SIGN UP TO VOLUNTEER TODAY!

WWW.CLEANACREEK.ORG | VOLUNTEER@VALLEYWATER.ORG

#CCD2016

TEACHER HOUSING

▶ Continued from page 5

Nelson said.

The argument led to a tense situation in which both Nelson and Rudolph spoke over each other several times, forcing Wheeler to call a break.

Board member Jose Gutierrez agreed with Rudolph's stance, and said the board could easily work through the superintendent to send out surveys, set up outreach meetings and get a better understanding of where district residents stand on any topic they please. Board member Bill Lambert said it's hard to separate a board member's role as a trustee and as a private citizen, and that all the board members need to be mindful of how they act in the community, no matter in what capacity they claim to be acting.

"The rest of the community looks to you as a public official," Lambert said. "You need to take that responsibility very seriously,

and understand when you are out there, you are acting on behalf of the school district."

The reason for the arguably premature outreach was because of past mistakes by the district, Nelson said. Back in 2000, the district had done extensive planning to have the Morgan Center, an autistic children's program in Los Altos, move to Cooper Park without first informing the public of the plans. Hundreds of residents showed up and claimed that the Morgan Center would not be a good fit for the residential area surrounding the park.

Nelson said he set out to avoid repeating the same mistake as the district considers its options for teacher housing. Through his own personal survey and meetings, he said, it appears there's very little interest in a housing development in Cooper Park, with one resident suggesting that the Cuesta Park Annex might even be preferable to sacrificing open space at Cooper Park. ▀



CELEBRATING 20 YEARS
Mentor Tutor Connection
Helping students achieve their potential and thrive

Opening for Executive Director

Mentor Tutor Connection, a local non-profit that recruits, trains and places volunteer mentors and tutors in MV and LA schools is seeking an Executive Director. This person will be "the face" of our organization and responsible for leadership and growth of MTC. Part-time, paid position. Desirable skills include effective communicator, ability to work with people of all ages, proficient computer skills, and nonprofit and fund development experience. Respond with your interest and a resume to programs@mentortutorconnection.org.

MentorTutorConnection.org



217 Ada Avenue #18, Mountain View Sophisticated and Contemporary Townhouse

Spacious and bright, this 2,009sf 3 bedroom, 2.5 bath end unit is perfect for today's buyers. Sophisticated styling and contemporary flair are evident throughout the 2-story floor plan, which features formal living, dining, and family rooms. The updated kitchen showcases granite counters, and stainless appliances.

- Attached 2-car garage
- Landscaped private outdoor patio space
- Sparkling pool and spa
- Children's area featuring play structures
- Close proximity to Google, and other major tech companies

Open Saturday and Sunday. 1:30-4:30

Offered at \$1,298,000
www.217AdaAve.com



DERK BRILL

Call Derk to schedule a one-on-one meeting at

CELL 650.814.0478

ALAIN PINEL REALTORS

578 UNIVERSITY AVENUE, PALO ALTO

CALBRE# 01256035

DBRILL@APR.COM

WWW.DERKBRILL.COM

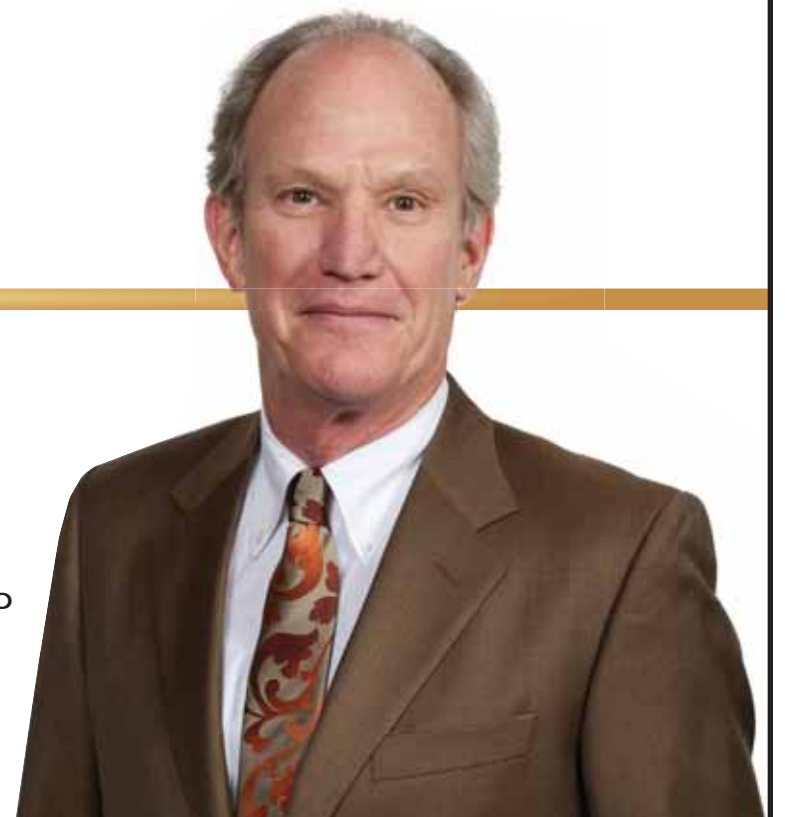

Berkeley's Counting Crows return to the Bay Area

By Linda Taaffe

Counting Crows frontman Adam Duritz now calls Greenwich Village home, but the singer/songwriter got his start as a musician in the Bay Area with his debut album, "August and Everything After," which went multi-platinum and catapulted the band into a music career that hasn't let up for 25 years.

Duritz grew up in Berkeley, spending many nights (often every

night) in coffee houses and clubs on both sides of the San Francisco Bay, watching shows at Shoreline Amphitheatre and once hanging out at the now-defunct Edge nightclub in Palo Alto (though he says he can't remember why).

Duritz and Counting Crows, who have gone on to sell more than 20 million albums, produce more than a dozen hit singles and play arenas around the world, will be back in the Bay Area at Shoreline Amphitheatre

on Saturday, Sept. 10, as part of a national tour the band is co-headlining with Matchbox Twenty's Rob Thomas, whom Duritz has known since the '90s. Joining them on tour is show opener K Phillips, a performer from The Outlaw Roadshow free concert series that Duritz helped launch seven years ago to give exposure to up-and-coming indie bands.

In a telephone interview with the *Voice's* sister paper, the Palo

Alto Weekly, last week, Duritz talked about what it's like coming back to the Bay Area and why this has been one of his most memorable tours.

What's it like coming back to play in the Bay Area?

It's a nightmare with the guest list mostly. No, it's really fun. A lot of my best friends, who are still my best friends, live here so it's really nice to come back. It does get a little hectic backstage,

but it's nice to see everybody.

How does it feel playing at the same venues where you grew up watching bands?

I saw many, many shows at Shoreline. It's cool. What I really remember is the Greek Theater, having gone to a million concerts there, and then walking to my first show there. I lived a few blocks away at the time, so I just walked. I mean that was really weird at first. But it's been so long now, I've spent more of my life playing these venues than I did going to see shows at them. ... The Greek is still my favorite place to play, maybe because I grew up going there or maybe because it's just a great venue.

Any old hangouts you go back to when you're in the area?

There's not as many clubs left. A lot of them are gone that I hung out in, and I don't go to many concerts or gigs while I'm on tour because it's too loud and people talk to me, and my voice gets wrecked because there's no way to be quiet. ... There were so many clubs in San Francisco that I have great memories of. ... Chris Isaak used to play at Night Break before he made records. We used to see him there all the time.

What was it like making music in San Francisco during the heyday of the '90s music scene?

It was pretty great. It seemed like everyone we knew was a musician back then. Immy (David Immergluck) — my guitar player — and I used to live together, and we were talking the other day about this one period in our lives when we were in the clubs every single night. We were either seeing our friends play, we were playing, or we were rehearsing every night, so it was like we were drowning in music at all times. There were so many bands in the Bay Area, you know, even like in our houses. I lived across the street from Les Claypool (of Primus).

What's it like touring with Rob Thomas — you go way back, right?

I haven't really seen Rob in about a decade, but it's been amazing. It's been the most fun I've had on tour in a long, long time. He's got a band full of the nicest people

► See *COUNTING CROWS*, page 16

Meet Your New Best Friend



Visit our Mt. View Neighborhood Adoption Center at
PetSmart • 2440 East Charleston Road • 408-425-1569



**DOG SHOWCASE
EVERY SATURDAY
AT 12-2PM!**



hssv.org/locations

■ INFORMATION

What: Counting Crows and Rob Thomas

Where: Shoreline Amphitheatre, 1 Amphitheatre Pkwy, Mountain View

When: Sept. 10, doors open at 6:45 p.m.

Cost: \$24-\$146

Info: <http://shoreline.amphitheater-mtnview.com>

9/11

► Continued from page 1

That morning, the ride on the subway was uneventful. The train wasn't even late the way it usually was. Schertzer took the elevator to his office on the 101st floor of the North Tower; Brody went to her 14th-floor office at the nearby Deutsche Bank, where she worked as an assistant vice president and financial analyst.

As she got to her desk, she heard the bangs and noise as the first plane struck the North Tower. Alarms went off everywhere. People rushed to the windows to see what was happening. A small plane had struck the tower, they were told, but no one had been killed.

Brody tried to call her brother but could not reach him. The first plane had hit just two floors below where he worked. Everyone above it was trapped, they would later learn.

Then the second plane hit the South Tower, which was attached to the Deutsche Bank building. Everyone was told to flee, and to run fast, Brody said.

"We had to run to the other side of the building because our windows were breaking. ... It was about running and more running, and more running. And the buildings collapsed around you," she said.

Pieces of debris rained down everywhere.

"You just ran and hid in alleys; you hid in alleys and doorways," she said. "I always said there was no such thing as chivalry, but the men were covering up women so that they would get whatever was flying in the air. (It) would hit them; it didn't hit us."

Brody kept running until she reached an office building down by the water. It was hours before she reached her frantic parents. No one had heard from her brother.

F-15s roared overhead below the rooftops of buildings and police ran through the streets, she said.

"No one knew what was going on. You just knew life wasn't going to be the same ever again. My life for sure wasn't the same ever again," she said. "Part of mine stood still, and still stands still in that moment."

At Cantor Fitzgerald, 658 employees died on five floors.

"They found a part of my brother. They told you where he was found and who he was found with," she said. Schertzer was found with his colleagues. Brody's DNA was used to identify her brother's remains.



Mountain View resident **Lori Schertzer Brody** said she's had a long road to recovery after escaping the 9/11 attacks on the World Trade Center. Her brother, who was working in North Tower, was not so lucky.

It would be years before she could begin emerging from her grief. She had survivor guilt; she could not sleep or work; she twice tried to kill herself, she said.

"It took seven years of individual therapy, hypnosis and sibling support groups," she said.

Hypnosis helped her to forget some of the most traumatic details.

"I was told that I walked around with a pillow with a picture of my brother on it and I wouldn't let anybody touch it," she said.

"I lost one of my best friends. None of my memories are without him. I remember him every day. I see him in my dreams."

Brody said she doesn't have much trust anymore. She profiles people when she looks around. She relies on a close circle of family and friends. In bad times, one finds out who is reliable, and which friends will disappear.

"I lost faith," she said. "I'm not sure there is a god up there anymore. ... I can't imagine someone allowing this to happen. It's really hard to reconcile that," she said.

But Brody has found ways to keep her brother's memory alive. She had a street named after him in their childhood hometown of North Edison, New Jersey; she got a bench dedicated to his memory in Central Park. A butterfly garden in his name was created at their childhood grammar school, funded by neighbors.

At her wedding, she set a place for him at her table.

He was the brother and son who would help anyone; the East Coast boy who was inexplicably a Dallas Cowboys fan; and an ardent music lover who followed the band Phish.

Brody, her husband and two

young children have lived in the Bay Area for five years, currently in Mountain View. But the Bay Area seems too far removed from the events of 9/11. Brody feels an uncomfortable divide between the East Coast, where the experiences are memorialized annually, and the West Coast, which doesn't seem to take much notice of the day.

"Back East, the major networks will run a memorial with the names at the bottom. Here, you are lucky if you see a five-minute glimpse as they are discussing the traffic on the highway.

"It's just an ordinary day. If you are back East it's not an ordinary day. It's families — it's people who died. It's not just a building that came down and the lawsuits over the buildings and the rents that were afterward," she said.

"There's 3,000 people that passed away with four planes going down. ... Those 3,000 people didn't get to live their lives. They all have family members. They have brothers, sisters, moms, dads, kids — some of those kids never even knew their parents.

"That's what people need to remember," she said.

Brody went — once — to the 9/11 Memorial Plaza, which occupies eight of the 16 acres at the World Trade Center. Waterfalls flow into two memorial pools ringed with bronze panels inscribed with the names of 9/11 victims and those who died in the 1993 World Trade Center bombing.

But it is also business as usual. A new commercial center has sprung up around the memorial, including the 1,776-foot-tall One World Trade Center and the as-yet-incomplete 1,270-foot-tall 2 World Trade Center, which is expected to open in 2020.

It doesn't feel right to have

buildings there, she said.

Upon entering the museum, Brody came across a room where the exhibits went into details.

"I lost it," she recalled. In the nearby recovery room for overwhelmed family members, Brody regained her composure. But she didn't go back in.

Brody has kept her experiences and her loss close to her heart. She doesn't talk about Scott, and most friends assume she is an only child. But she hopes that coming forward will help people to remember 9/11 and what it means. There is still a threat out there, she said, and Americans should always remember those who died, even if they did so 3,000 miles across the country. Ultimately, those events and all that followed has affected everyone.

Brody said she has come to many personal realizations over the past 15 years.

"I fought long and hard to get to a point where I'm a survivor. There's not much that can be done to me anymore that I can't survive.

"You learn your family is the most important thing in the world," she said. "In my house we always say we love each other every day. And we give each other hugs because you don't know when the last one is going to be." ❑

Email Sue Dremann at sdremann@paweeekly.com.

SEE MORE
ONLINE

mv-voice.com

Lori Schertzer Brody tells her story of 9/11 and the lasting impact it's had on her, plus recollections of her brother, Scott, in a video. Watch it now on mv-voice.com or YouTube.com/paweeekly.

Free Admission!

#MVArtWine

SEPTEMBER 10 & 11, 2016

A CULTURAL COMMUNITY CELEBRATION

THE BAY AREA'S BEST ART & WINE FESTIVAL

SATURDAY 11AM-7PM ★ SUNDAY 10AM-6PM

CASTRO STREET ★ DOWNTOWN MOUNTAIN VIEW

600 EXCEPTIONAL ARTISTS

STELLAR LIVE MUSIC EVERYWHERE

ORGANIC & GREEN PRODUCTS ★ FABULOUS FOOD & DRINKS

TASTY CRAFT BEER ★ PREMIUM WINES

REFRESHING MARGARITAS & SANGRIA

SMASHING ENTERTAINMENT
ON STAGE & STREET

Ruckatan ★ The Houserockers ★ The Hitmen
Pacific Soul Band ★ The Blackouts
Blue House Man In White ★ The GroWiser Band

John Clarke ★ Ancient Winds ★ HeartStrings Music ★ Bob Culbertson ★ Orquesta Borinquen

AWESOME ACTION-PACKED KID'S PARK

"Mountain View's Got Talent Community Stage" ★ Wild & Wacky Waterballerz
Ultra-Thrilling Bungee Jump ★ Daunting Climbing Wall ★ Obstacle Course
Hula Hooping ★ Party Animal Puppets ★ Exotic French Hair Braiding
Super Cool Henna Tattoos & Face Painting ★ Caricature Art

PROUDLY PRESENTED BY

LinkedIn

Google

Kaiser Permanente

RecoLogy

San Jose Valley Water District

THE ALL-NEW PRIUS

Sutter Health Palo Alto Medical Foundation

xfinity

KBCW

Peninsula Open Space Trust

Metre

Stanford

Mountain View VOICE

STAR ONE

S.C.O.

WELLS FARGO

Mixto's

upee

Silicon Valley

560 KSFQ

95.3 KRITV

lyft

KCBS

Hotel Avante

LEADERSHIP MOUNTAIN VIEW

Calculus

560 KSFQ

KPIX

Modelo Especial

KO-810

i love LUV

94.5 KRAY

HONEST tea

SILICON VALLEY Community Foundation

Alice @ 97.3

CELEBRATING 45 GREAT YEARS!

Chamber of Commerce CHAMBERMV.ORG ★ MIRAMAREVENTS.COM
MOUNTAIN VIEW | CALIFORNIA INFO: 650.968.8378 ★ NO PETS ★ NO SEGWAYS

COUNTING CROWS

► Continued from page 14

ever. We have this running text between me and him and K (Phillips). On the first night of the tour, I sent out a text and said, 'Hey, what a great night guys. That was a really good show.' I thought that would be the last time we would use that text, instead it's been running for a month or a month and a half now. It's been that kind of tour where we'll all watch everyone play every night, and we all hang out a lot. We were just talking the other day about how we would like to find a way to do this every summer.

What are your plans after the tour?

I have the Outlaw Roadshow coming up ... and I need to go to Nashville because I promised a few friends I'd sing on their record. There is a new Dashboard Confessional record that I want to sing on. ... Then, I don't know, I might take some time off this fall.

Are you working on a new album?

We've started doing the first work for ideas for a song a few months ago ... but we're just in the beginnings of it. ▣



COURTESY OF THE CITY OF MOUNTAIN VIEW

The East Whisman area, shaded in blue, currently has no housing but council members said they'd like to change zoning to allow residential development.

EAST WHISMAN

► Continued from page 5

whether additional office growth should be allowed in the area as well — an idea that was not embraced by a majority of council members.

Mayor Pat Showalter said allowing residential development is important in light of the housing crisis in the Bay Area, and that the majority of residents who attended the community workshop meeting on the precise plan in July overwhelmingly supported residential zoning.

"We heard loud and clear from the people at the workshops that they were very interested in housing," Showalter said.

Council member Mike Kasperzak, who was absent but sent in written comments, said he supported taller, denser housing along Middlefield Road, Whisman Road and Ellis Street that should feel more urban than suburban. At the same time, Kasperzak added that he doesn't see the need to add more offices beyond what's allowed in the existing precise plan, and questioned whether new businesses coming into the area provide a significant economic advantage to the community.

Other areas to be studied for housing won tepid support at best. Council member Lenny Siegel said he supported studying housing north of Maude Avenue, but worried that air traffic from nearby Moffett Federal Airfield could make it an undesirable place to live.

"I'm concerned about noise levels," Siegel said. "I don't want to create a situation where, if there's increased usage of the airfield, there's a problem five or 10 years down the road."

Council support for housing stopped short of extending south of Highway 237, an area council members feared would be isolated from the rest of the community. A number of the lower-density offices south of Highway 237 are occupied by smaller companies and startups, which council members argued should not be displaced by changes in the zoning.

Council member John Inks, who did not lend his support to the residential-heavy vision for the area, said he was worried that re-zoning for residential could quash existing and future office developments. Inks suggested that more outreach be done with local business owners on where housing can be put.

Wally Singleton, workplace planner for Symantec, said company officials are concerned about losing development entitlements for 130,000 square feet of the company's campus if the new zoning precludes office develop-

ment. Symantec acquired the company Blue Coat Systems in June, and faces adding about 500 employees at a time when the city is considering squeezing down office growth in the area, Singleton said.

One of the big concerns facing council members was whether a new neighborhood in the East Whisman area would feel like an isolated pocket of residential buildings, rather than a neighborhood connected to the rest of the city. Vice Mayor Ken Rosenberg said he was concerned that housing along Ellis Street would feel like an island surrounded by office buildings, and residents would be forced to leave the area to enjoy parks and other typical neighborhood amenities.

Senior city planner Lindsay Hagan said the change will have to happen over time, and that the hope is that standalone residential developments will eventually reach a critical mass. There's also significant housing growth planned south of the precise plan area, which could connect to form a larger community in an area currently dominated by industrial buildings.

"The intent and interest is to get enough volume of residential land use where it could, in fact, create enough units to encourage that kind of urban neighborhood," Hagan said.

Despite the interest in creating a more urban feel to the area, school board member and council candidate Greg Coladonato told council members that he didn't see a lot of support in the community workshop for massive high-rise buildings that would make the area look like downtown San Jose. Several members of Mountain View's Environmental Planning Commission talked about residential buildings as tall as 10 stories, Coladonato said, which he felt would not be a good fit for the area.

"I don't think we need to go higher than five or six stories," he said. "That seems too intense for the neighborhood."

A portion of the precise plan area is affected by the large groundwater plume contaminated by trichloroethylene (TCE), a Superfund site bordered by Middlefield, Ellis and Whisman roads. Siegel argued that it should not pose a major barrier to building housing in the area. There are strategies for avoiding toxic vapor intrusion in homes, he said, including building ground-floor garages and retail to provide a buffer between residents and the carcinogenic chemicals beneath the soil.

"As far as I can tell, there's no serious obstacle to building housing on any of the areas we're looking at," he said. ▣

Stanford | Continuing Studies

FALL 2016



Professional & Personal Development

Featured Fall Courses:

Accelerate Your Startup Idea • Tame Big Data to Drive Big Insight

Financial Planning: Part I • Building a Career of Meaning and Impact

Neuromarketing: How Brain Science Is Changing Marketing as We Know It

Contemporary Business Issues in Sports • How to Think Like a Futurist

Stanford Continuing Studies offers a broad range of on-campus and online courses in liberal arts & sciences, creative writing, and professional & personal development.

Courses are taught by notable Stanford faculty, experienced professionals, and leaders in their fields. All adults are welcome to attend.

Fall registration is now open and most classes begin the week of September 26.

Learn more and register: continuingstudies.stanford.edu



963 Celia Drive, Palo Alto Offered at \$1,988,000

Extensive Updates and Open Layout

A fully functional design complements this thoughtfully upgraded 3 bedroom, 2 bathroom home of 1,622 sq. ft. (per county) standing on a lot of 6,086 sq. ft. (per city) with a private well. The sunny, open common areas are privately arranged towards the rear of the home, overlooking the backyard retreat. Highlights include Caesarstone countertops, VELUX skylights, and a stylishly remodeled kitchen. Live within moments of parks, shopping, commuter routes, and top-ranking Palo Alto schools.



OPEN HOUSE

Saturday & Sunday, 1-5 pm
Complimentary
Lunch & Lattes



For video tour & more photos, please visit:
www.963Celia.com

650.488.7325 | info@deleonrealty.com | www.deleonrealty.com | CalBRE #01903224

Viewpoint

- EDITORIAL
- YOUR LETTERS
- GUEST OPINIONS

MountainView
VOICE

Founding Editor, Kate Wakerly

■ STAFF

EDITOR

Andrea Gemmet (223-6537)

EDITORIAL

Associate Editor

Renee Batti (223-6528)

Arts & Entertainment Editor

Karla Kane (223-6517)

Special Sections Editor

Linda Taaffe (223-6530)

Staff Writers

Kevin Forestieri (223-6535)

Mark Noack (223-6536)

Photographer

Michelle Le (223-6530)

Editorial Intern Sanjana Garg

Photo Intern Brenten Brandenburg

Contributors Dale Bentson, Trevor Felch,

Mimm Patterson, Ruth Schecter

DESIGN & PRODUCTION

Marketing and Creative Director

Shannon Corey (223-6560)

Design and Production Manager

Kristin Brown (223-6562)

Designers Linda Atilano, Diane Haas,

Rosanna Leung, Paul Llewellyn,

Nick Schweich, Doug Young

ADVERTISING

Vice President Sales and Marketing

Tom Zahiralis (223-6570)

Advertising Representative

V.K. Moudgalya (223-6586)

Real Estate Account Executive

Rosemary Lewkowitz (223-6585)

Published every Friday at

450 Cambridge Avenue

Palo Alto, CA 94306

(650) 964-6300 fax (650) 964-0294

Email news and photos to:

editor@MV-Voice.com

Email letters to: letters@MV-Voice.com

News/Editorial Department

(650) 964-6300 fax (650) 964-0294

Display Advertising Sales

(650) 964-6300

Classified Advertising Sales

(650) 964-6490 • (650) 326-8286

fax (650) 326-0155

Email Classified ads@MV-Voice.com

Email Circulation

circulation@MV-Voice.com

The Voice is published weekly by Embarcadero Media Co. and distributed free to residences and businesses in Mountain View. If you are not currently receiving the paper, you may request free delivery by calling 964-6300. Subscriptions for \$60 per year, \$100 per 2 years are welcome.

©2016 by Embarcadero Media Company. All rights reserved.

Member, Mountain View Chamber of Commerce



■ WHAT'S YOUR VIEW?

All views must include a home address and contact phone number. Published letters will also appear on the web site, www.MountainViewOnline.com, and occasionally on the Town Square forum.

Town Square forum

Post your views on Town Square at MountainViewOnline.com

Email your views to letters@MV-Voice.com. Indicate if letter is to be published.

Mail to: Editor
Mountain View Voice,
P.O. Box 405
Mountain View, CA 94042-0405

Call the Viewpoint desk at 223-6528

■ EDITORIAL THE OPINION OF THE VOICE

Schools show progress in narrowing achievement gap

Much as we wish it were otherwise, most change is slow, and difficult. Last year, when the first Common Core-aligned standardized test scores revealed an unacceptably wide achievement gap among students in the Mountain View Whisman School District, district administrators and school board members intensified their commitment to improving the educational performance of those on the unenviable side of the gap: minority, economically disadvantaged and disabled kids. But no one thought it would be easy.

Under the leadership of Superintendent Ayinde Rudolph, the district's doubled-down efforts led to a range of new programs that include after-school help, longer school days, more emphasis on teacher development, and a boost in remedial help for kids who had fallen behind.

One year later, there's encouraging news. Student test scores at the district's two schools with the highest number of disadvantaged kids — Castro and Theuerkauf — were significantly higher than last year's, with a greater increase in scores among those students than the districtwide 6 percent boost in both English-language arts and math.

One year's test scores can't be seen as locked-in success of the district's efforts to boost student performance among disadvantaged kids, and the commitment to narrowing the achievement gap must continue. But there is much to cel-

brate in the glow of this development. The district had committed \$538,000 to create the programs that are likely to be fueling these gains, and it will be harder for critics to make the tired argument that schools can't "throw money at" problems to fix them. Increased funding for professional staff and programs designed to eliminate poor student performance and close the achievement gap is money well spent.

We wish there were better news from the Mountain View-Los Altos High School District, however. Among all junior-level students tested, scores in English-language arts fell from 75 percent last year to 69 percent this year. And in math, there was a drop from 65 percent to 64 percent. But the test-score decline was even greater among Latino and economically disadvantaged students.

Superintendent Jeff Harding told the *Voice* that staff will be reviewing data to figure out why test scores fell this year. But he tried to put a positive spin on the situation by noting that students do well on tests such as Advance Placement exams and the SAT. While no one can complain about that, those tests largely involve kids with many more advantages in life than those on the other side of the achievement gap. Our schools must be committed to helping all kids learn and thrive in the classroom. There is considerably more work to be done in our local high schools to achieve that goal. ■

■ LETTERS VOICES FROM THE COMMUNITY

CASTRO STREET'S 'VASO' WORTH CELEBRATING

On Sunday, Aug. 28, my wife and I had the pleasure of experiencing a slice of downtown Mountain View culture and cuisine at the 17th anniversary celebration of Vaso Azzurro Ristorante on Castro Street.

The restaurant was packed, celebrants spilling out to the street-side tables with the echo of live jazz music and the buzz of conversation wafting all around. Loyal customers celebrated the occasion with the Sadri family, enjoying wonderful food and wine and enjoying an unforgettable time together. The Sadri family and their personable staff never cease to amaze and delight with their delicious Northern Italian dishes and friendly, vibrant setting. This anniversary is a reminder that the Sadri family remain committed to a "spirit of hospitality," providing their customers with a memorable dining experience each and every visit.

I'm not sure how long it takes for a business to be classified as an institution. In our humble estimation, Vaso Azzurro is all that and more for Mountain View. If you haven't dined there before or if it's been a while, stop by and prepare to smile!

Jeff and Sandy Burgan
Perich Court

VEGETARIAN MENU OPTIONS LACKING

I was thrilled to see My Nguyen's article in the food section (Aug. 26) dedicated to vegan/vegetarian eating, and I applaud the start up of such restaurants. Alas, upon reading further, I discovered that I had been to the restaurants mentioned and they do not meet my expectations for healthy fare. I do not consider processed, fried, genetically engineered food "healthy."

This is why so many vegetarian folks are not truly healthy and are overweight. They still eat processed, fried foods and often include dairy.

A whole-foods plant-based diet is scientifically proven to restore health and arrest the chronic conditions plaguing our society, today. If you look at your plate, and you can see the whole food (vegetables in their original state as well as beans, lentils, whole grains, whole fruits), you are eating plant-based. Too many of the dishes at the aforementioned restaurants are processed and use breading and sauces loaded with oil, sugar and salt. When asked if the food is organic or

non-GMO, I am met with a blank stare.

We desperately need a place to eat here on the Peninsula that is truly healthy on the lines of the menus in the movies "Forks Over Knives" or "Plant Pure Nation." It's not hard to do, and such dishes are very tasty. Those of us who want a break from cooking at home would welcome such a place or at least an item on the menu that satisfies this style of eating.

Patricia Evans
Sierra Vista Avenue



JUST LISTED

330 GALLI COURT, LOS ALTOS

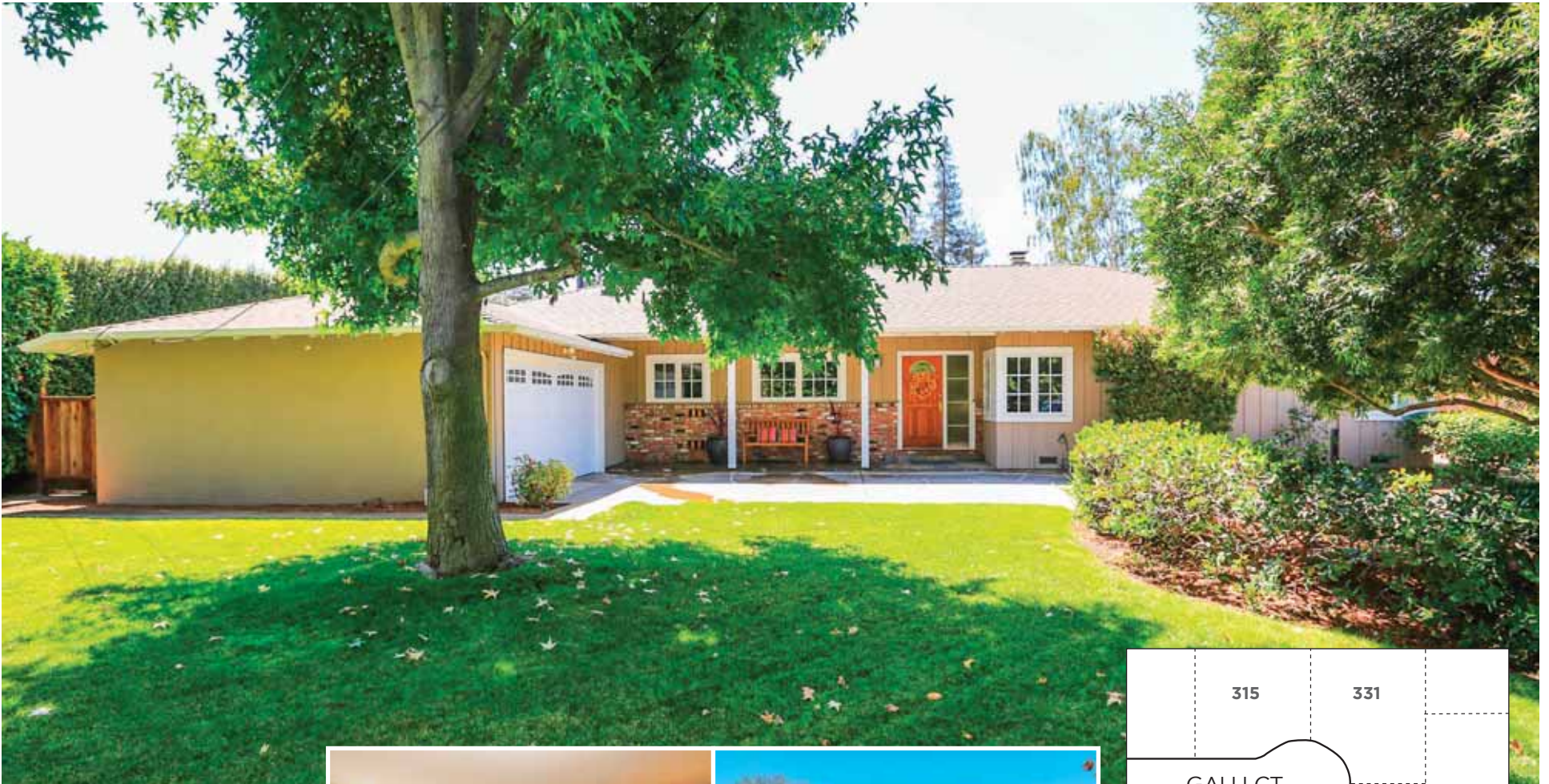

**OPEN HOUSE
SAT & SUN
1:30-4:30**

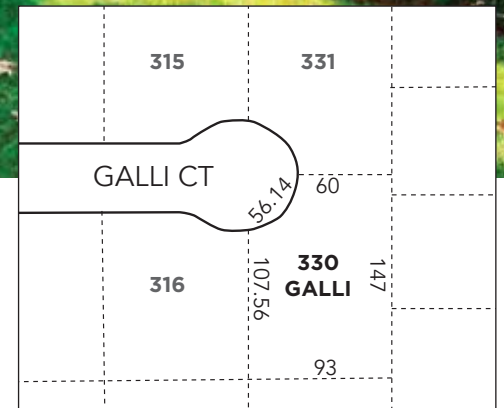

4 bedrooms
3 bathrooms
±2,568 SF home
±13,000 SF lot

NORTH LOS ALTOS RAMBLER

- Walk to downtown Los Altos
- Living room with fireplace
- Separate dining room
- Family room with fireplace
- Oversized two-car garage
- Air-conditioning
- Serene gardens with mature shade trees and drought-tolerant landscaping

Los Altos Schools: Almond Elementary, Egan Junior High School, Los Altos High School

**OFFERED AT
\$2,898,000**



KATHLEEN WILSON
Mobile: 650.207.2017
kwilson@apr.com
KathleenWilsonHomes.com
DRE# 00902501



Square footage and/or acreage information contained herein has been received from seller, existing reports, appraisals, public records and/or other sources deemed reliable. However, neither seller nor listing agent has verified this information. If this information is important to buyer in determining whether to buy, buyer should conduct buyer's own investigation.



I can see your house from here!

If planning to make a move, you can count on me
to make sure you land safely in the right place!

**Find me Saturday at the Art & Wine Festival
for a FREE drink token**

No one knows your neighborhood like your neighbor



KIM COPHER

650.917.7995

kim.copher@cbnorcal.com

www.justcallkim.com

CalBRE #01423875

International President's Elite

